



Honeybourne Road NW6

Parkheath
Sold on Service





Honeybourne Road, NW6, £850,000, Leasehold - Share of Freehold

Camden Band E

- Rarely available 2 bedroom, 2 bathroom apartment
- Ground floor of popular purpose built red brick building
- 930 sq ft / 86.40 sq m
- Spacious and unusual open plan living and eat-in kitchen arrangement
- Fantastic finish throughout
- Master bedroom with en-suite bathroom
- Further bedroom with period fireplace and family bathroom
- Share of Freehold
- Central West Hampstead location
- 8 minute walk to West Hampstead transport hub (Overground, Thameslink and Jubilee lines)

Belsize Park/Hampstead
208 Haverstock Hill
NW3 2AG
Sales 020 7431 1234
Lettings 020 7431 3104
nw3@parkheath.com

Kensal Rise
54-56 Chamberlayne Rd
NW10 3JH
Tel 020 8960 4845
kensal@parkheath.com

South/West Hampstead
192 West End Lane
NW6 1SG
Sales & Lettings
Tel 020 7794 7111
192@parkheath.com

Property Management
192 West End Lane
NW6 1SG
020 7433 6174
pm@parkheath.com

www.parkheath.com

Parkheath
Sold on Service

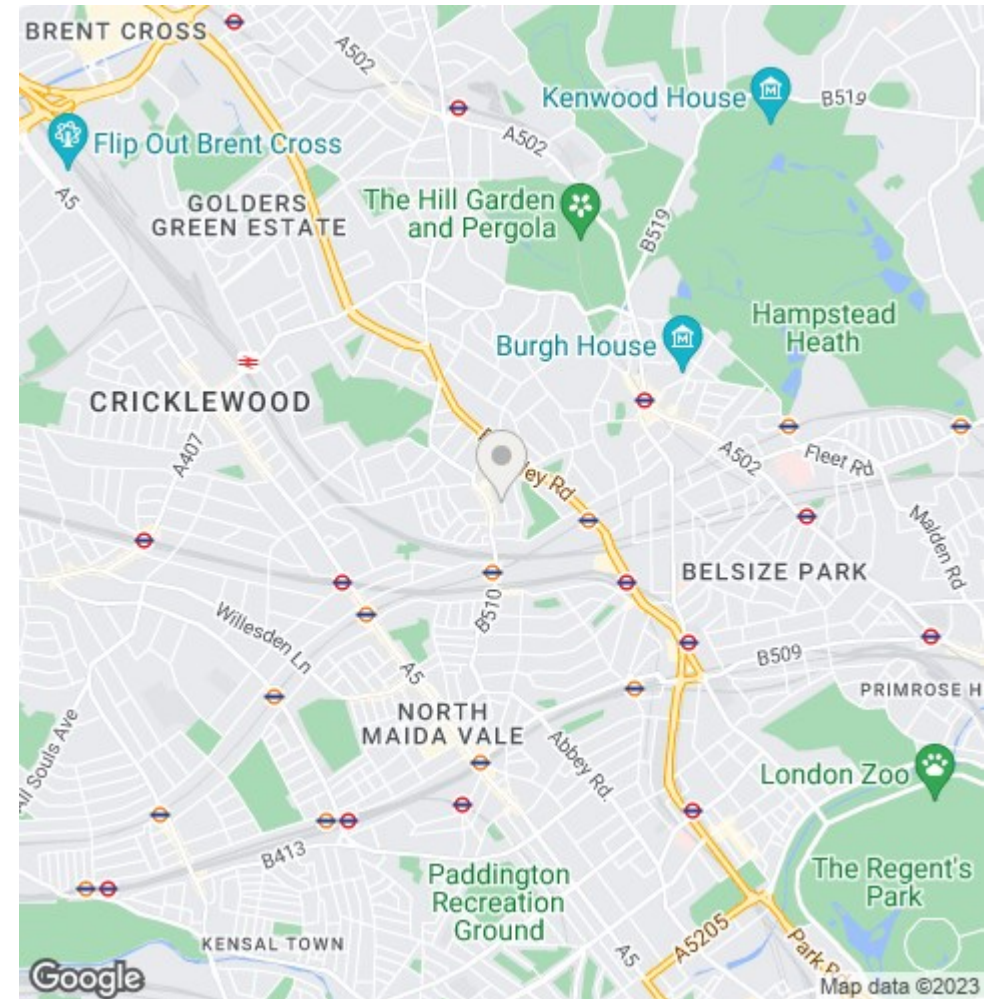
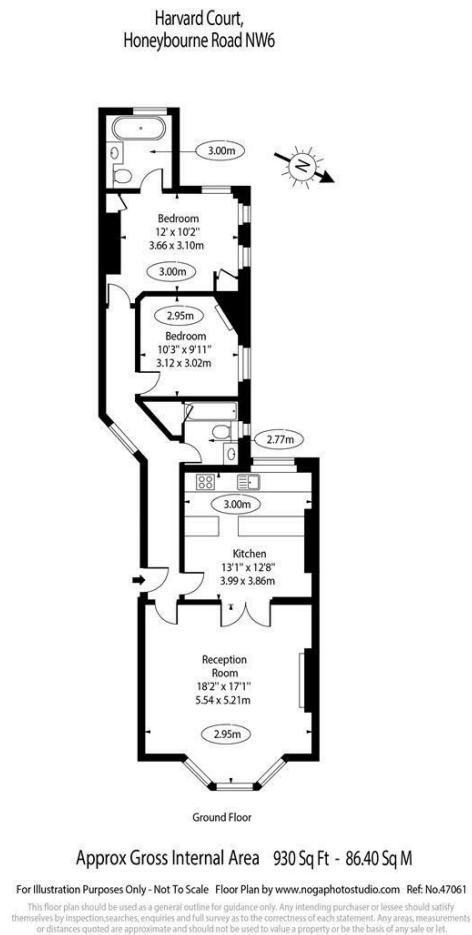

The particulars do not constitute part of an offer or contract. The particulars, including text, photographs and plans, are for the guidance only of prospective purchasers/tenants and must not be relied upon as statements of fact. The descriptions provided therein represent the opinion of the author and whilst given in good faith should not be construed as statements of fact. Nothing in these particulars shall be deemed a statement that the property is in good condition or otherwise or that any services or facilities are in good working order. All measurements are approximate